

T-BAR STAX | Order Specification Guide

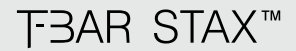

Product Name	LED/K Color	Light Output	Grid Size	Grid Type	Optic	Mounting Clips	Color	Driver	Options
TBSX = T-BAR STAX for Armstrong DesignStackz™	HW = 3000K MW = 3500K MN = 4000K HN = 4500K CN = 5000K 90 CRI available, on request.	LO = Low MO = Medium HO = High Custom lumen outputs available, consult factory.	20 = 2' XM to XM 22 = 2' XM to XL Z = Z Kit	15 = 9/16"	D = Diffusing Lens DW = Diffused White Lens B = Block Clear Diffusing Lens B2 = Block Frosted Diffusing Lens	A = Armstrong DesignStackz™ Ceiling	W = White B = Black C = Custom	UNV = Universal 120-277V 0-10V dimming POE = Power over Ethernet*	CP = Chicago Plenum LA = Lutron Athena Optional EM Battery Kit available (sold separately).

www.jlc-tech.com/patents

*For PoE, consult factory

Diffusing Lens (D)



Diffused White Lens (DW)



Block Clear Diffusing Lens (B)



Block Frosted Diffusing Lens (B2)



NOTES:

T-BAR STAX is designed for seamless integration into DesignStackz Ceiling Systems by Armstrong® World Industries. Create unique shapes and patterns beyond the traditional ceiling layout. Armstrong Ceiling clips allow for easy installation, just as you would install a typical cross tee. Available with a "Z" kit to create a fully illuminated shape within the 4' x 4' DesignStackz module.

APPLICATIONS:

Executive, Medical, Health, Educational, Retail, Hotels, Airport, Hospitality and any open space areas that require a unique and elegant architectural lighting design.

MOUNTING:

Integrates with Armstrong's DesignStackz 9/16" Suprafine® Suspension Systems. Compatible with DesignStackz Ceiling Tiles.

MATERIALS:

Anodized and painted aluminum extruded body, steel mounting clips, PC end caps, high transmitting acrylic PMMA lens.

ELECTRIC:

Universal input voltage of 120V – 277VAC. Junction box installed on fixture with integral driver, (single driver provided with remote mounted junction box for "Z Kit" configuration) and wire nuts inside for connection to line voltage and 0-10VDC dimming system. Fixture must be installed in accordance with local electrical codes. For EM Battery Kit order separately. PoE options available, consult factory. Refer to photometric page for wattage information.

WARRANTY:

5 years limited warranty. For complete warranty terms, please visit our website.

LISTINGS:

ETL/cETLus CE RoHS Indoor use only.



The T-BAR STAX is specifically designed for DesignStackz by Armstrong® World Industries. To learn more about this ceiling system visit www.armstrongceilings.com/designstackz



Photometrics CRI = >82

$L_{80} > 60K$ hrs

Diffusing Lens – Grid Type: 15

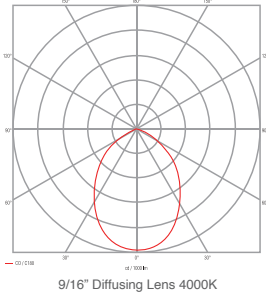

Code Selection	Output (lm/ft)	Power (watts/ft)	Efficacy (lm/W)
LO = Low	282	3.3	85
MO = Medium	440	5.2	84
HO = High	806	9.5	85

Diffused White Lens – Grid Type: 15

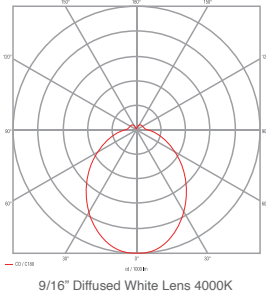

Code Selection	Output (lm/ft)	Power (watts/ft)	Efficacy (lm/W)
LO = Low	196	3.3	60
MO = Medium	311	5.2	60
HO = High	560	9.5	59

Block Clear Diffusing Lens – Grid Type: 15

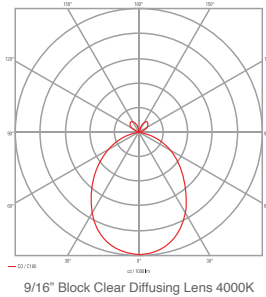

Code Selection	Output (lm/ft)	Power (watts/ft)	Efficacy (lm/W)
LO = Low	274	3.3	83
MO = Medium	436	5.2	84
HO = High	797	9.5	84

Block Frosted Diffusing Lens – Grid Type: 15

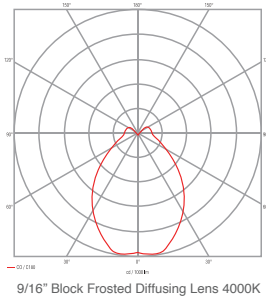

Code Selection	Output (lm/ft)	Power (watts/ft)	Efficacy (lm/W)
LO = Low	280	3.3	85
MO = Medium	445	5.2	86
HO = High	813	9.5	86

Profile Dimensions (Compatible with DesignStackz Ceiling Tiles)

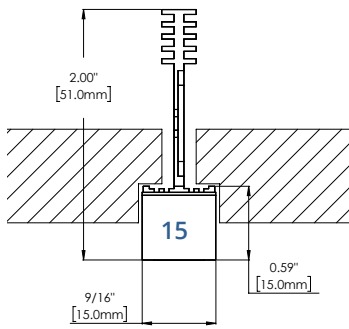

9/16" Diffusing Lens
TBSX-XX-X-15-D-A-X-X

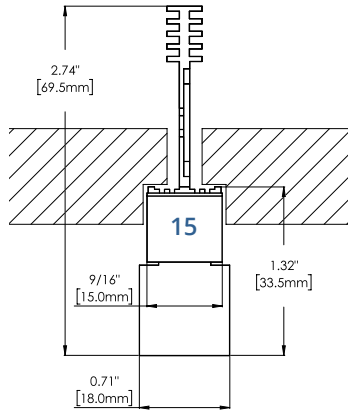

9/16" Block Lens
TBSX-XX-X-15-B/B2-A-X-X

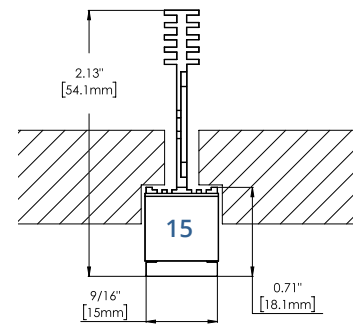

9/16" Diffuse White
TBSX-XX-X-15-DW-A-X-X

Clear block and frosted block variable heights 1/2" - 4" available, consult factory.

Length Dimensions

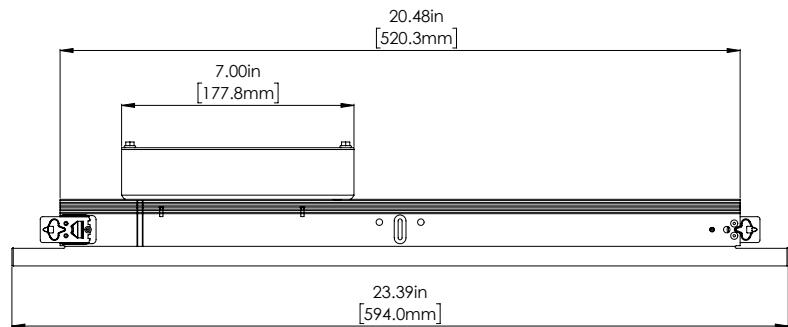
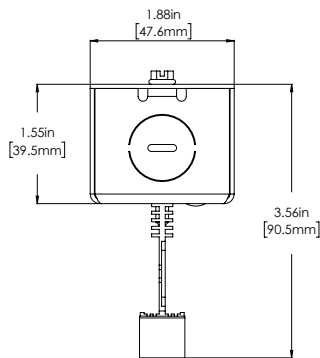

TBSX-XX-XX-20-15-X-A-X-UNV (Replaces Armstrong Item # XMM7524)

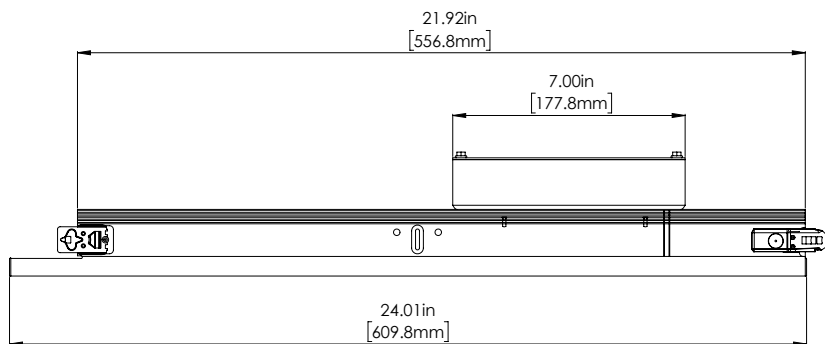
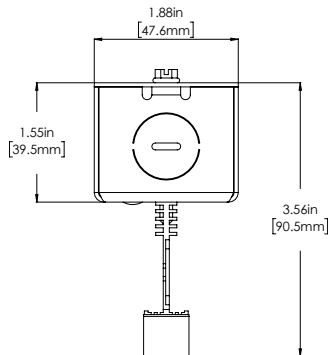

TBSX-XX-XX-22-15-X-A-X-UNV (Replaces Armstrong Item # XML7524)

Grid Size	Description	Grid Type	Replaces DesignStackz ceiling Item Number
20	2' XM/XM	9/16"	XMM7524
22	2' XM/XL	9/16"	XML7524
Z	Z Kit	9/16"	(2) XML7524, (1) XMM7524

DesignStackz Ceiling layouts can also utilize standard length 2ft and 4ft Suprafine 9/16" cross tees with 2x2 and 2x4 tiles. For other layouts utilizing DesignStackz 2ft and 4ft cross tees please refer to the T-BAR LED X-Series product line at www.jlc-tech.com/x-series

Z Kit Configuration

Using the T-BAR STAX with the Armstrong DesignStackz ceiling system allows for a fully illuminated Z shape of light within the DesignStackz 4' x 4' module. The "Z" kit configuration comes with (2) 22" T-BAR STAX and (1) 20" T-BAR STAX fixtures, and a single power supply is provided for the entire kit.

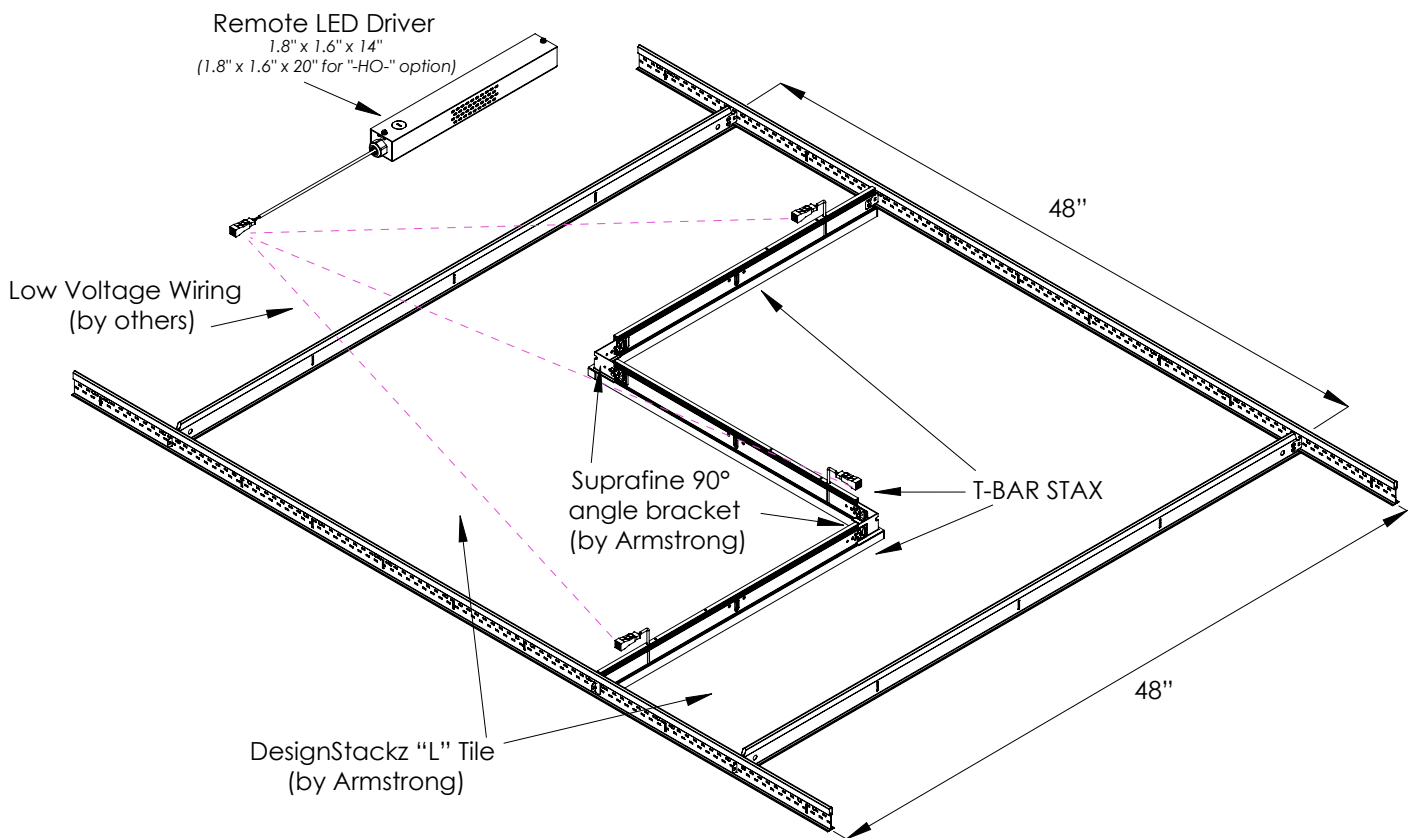

The T-BAR STAX is specifically designed for DesignStackz by Armstrong® World Industries. To learn more about this ceiling system visit www.armstrongceilings.com/designstackz

